

The background of the image is a close-up, high-resolution photograph of wood grain. It shows several cross-sections of logs, with the most prominent one in the foreground displaying clear, concentric growth rings. The wood has a warm, natural brown color palette. A semi-transparent, dark brown horizontal band is overlaid across the middle of the image, serving as a background for the text.

*SPECIALISATION PROJECT*

# ***TABLE OF CONTENT***

- 
- 01** CLIENT PROFILE
- 
- 02** SITE ANALYSIS
- 
- 03** CONCEPT BOARD -WABI SABI
- 
- 04** INSPIRATION BOARD
- 
- 05** MOODBOARD & FURNITURE BOARD
- 
- 06** CASE STUDIES
- 
- 07** AREA REQUIREMENT CHART
- 
- 08** ANTHROPOMETRIC STUDY
- 
- 09** CAFÉ LAYOUTS
- 
- 10** 3D VISUALIZATIONS
- 



# CLIENT PROFILE

## CLIENT DETAILS:

- Name: Ms Ananya Sharma
- Age: 35
- Profession: Entrepreneur , Food & Beverage Factory
- Location: Delhi, India
- Values: Simplicity, Sustainability, Nature-Inspired Living

## FUNCTIONAL NEEDS

- Seating capacity for 30–40 people
- Indoor and outdoor seating areas
- Comfortable dining layout
- Efficient service / barista counter
- Kitchen and preparation area
- Storage space for café supplies
- Comfortable waiting / ordering space near the counter

## BACKGROUND

- Passionate about café culture and hospitality
- Interested in creating calm social spaces
- Inspired by natural and minimal interiors
- Wants to create a relaxing café experience

## VISION FOR CAFÉ:

Create a peaceful nature-inspired café

- Reflect **Wabi-Sabi** design philosophy
- Encourages slow living and relaxation
- Provide a warm and welcoming atmosphere

## SPACE REQUIREMENTS

- Washroom facilities
- Clear circulation for customers and staff
- Indoor greenery and natural elements
- Calm lighting and acoustic comfort

“Zen Leaf Café is designed as a space where conversations flow as smoothly as coffee, and every corner invites people to slow down and enjoy the experience.”

- Ms. Ananya Sharma







**Wabi-Sabi embraces the beauty of imperfection, simplicity, and natural authenticity. Through raw textures, muted tones, and organic forms, the design creates a calm and timeless environment.**

# WABI SABI Inspiration Board

Organic forms



Minimal seating

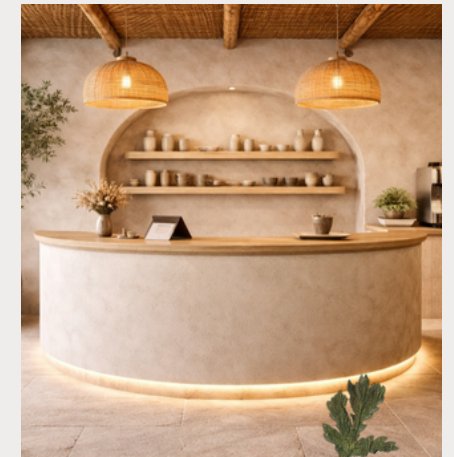

Reference images guided the design of seating, counter, washroom and spatial experience



Warm lighting



# Material & Furniture Moodboard

(INDOOR SEATING)



Natural Woven Rattan  
Pendant Light

Jute Rug Texture



Stucco Wall Finish



Limestone Flooring Tile



Solid Walnut Pedestal Table



Black Marble Café Table



Pampas Grass in Glass Vase



Bouclé Upholstered Café Chair



Bouclé Cylindrical Café Chair





SDA Market is a vibrant commercial area known for cafés, retail outlets, and a youthful atmosphere. The location attracts students, young professionals, and local residents, making it an ideal setting for a social and community-oriented café environment.



Nukkad Café demonstrates how thoughtful spatial planning and contextual design can transform a compact area into a lively and inviting social space that reflects the character of a neighborhood gathering spot.



The café combines indoor and semi-outdoor seating to efficiently use the available space while maintaining openness. Materials such as exposed brick, reclaimed wood, and metal accents create a warm and casual atmosphere. Soft ambient lighting and varied seating arrangements enhance comfort and encourage relaxed social interaction.



# CASE STUDY 01

## Nukkad Bar & Café, SDA Market, Delhi (AREA BASED)

Nukkad Bar & Café, located in SDA Market, Hauz Khas, New Delhi, is a casual dining space designed by Chromed Design Studio. The café covers an approximate area of 2,000–3,000 sq. ft. and is inspired by the concept of a traditional “nukkad”, creating an informal and social gathering environment. The design focuses on warm materials, relaxed seating, and an inviting atmosphere that encourages community interaction.





# CASE STUDY 02

(WABI SABI INSPIRED CAFE)

The Commoner's Kitchen in Surat, designed by Co:De Studio, reflects the Wabi-Sabi philosophy through natural materials, handcrafted furniture, and warm lighting that create a relaxed café atmosphere.



## 01. Wabi-Sabi Concept:

Wabi-Sabi is a Japanese design philosophy that celebrates simplicity, imperfection, and natural authenticity. It emphasizes organic materials, muted tones, and minimal design to create calm and balanced spaces.

---

## 02. Materials & Spatial Atmosphere:

The interior features raw wood, textured stucco walls, acacia wood flooring, and woven cane lighting. Earthy tones and soft ambient lighting enhance the warm and natural character of the space.

---

## 03. Design Learning for My Café:

From this case study, key design principles such as the use of natural materials, neutral tones, soft lighting, and simple forms can be applied to create a peaceful and authentic café environment inspired by the Wabi-Sabi philosophy.

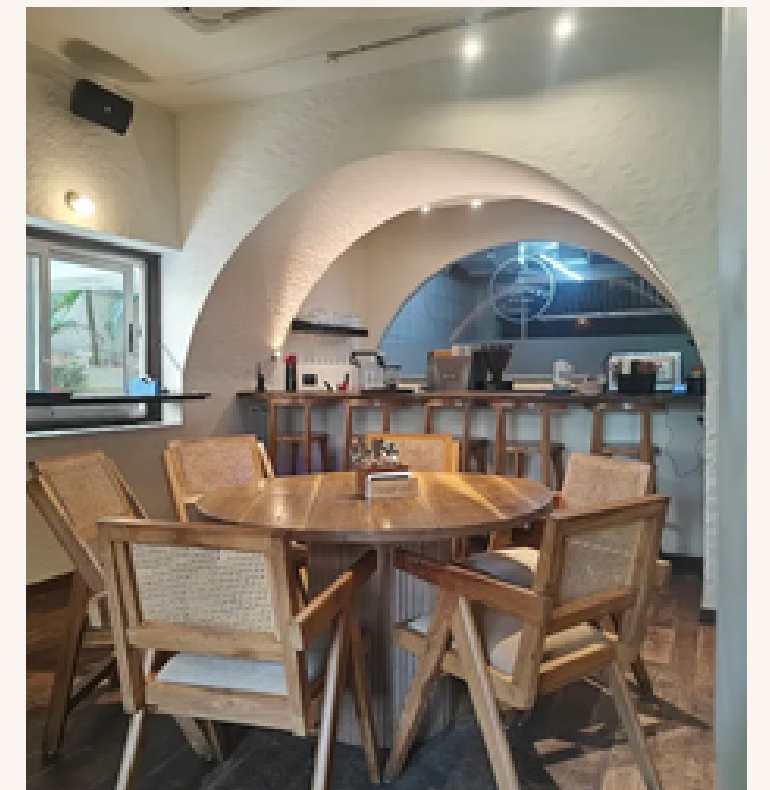

# *“Visual Inspiration Board: The Commoner’s Kitchen, Surat”*

**Stucco Walls**

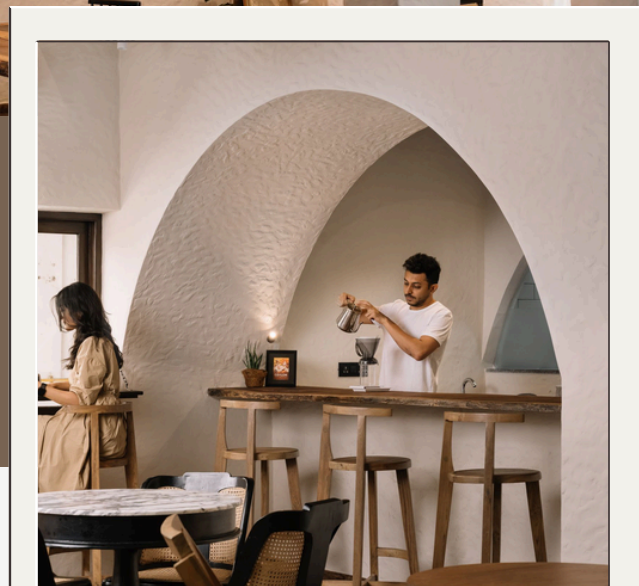

**Pendant Lights**

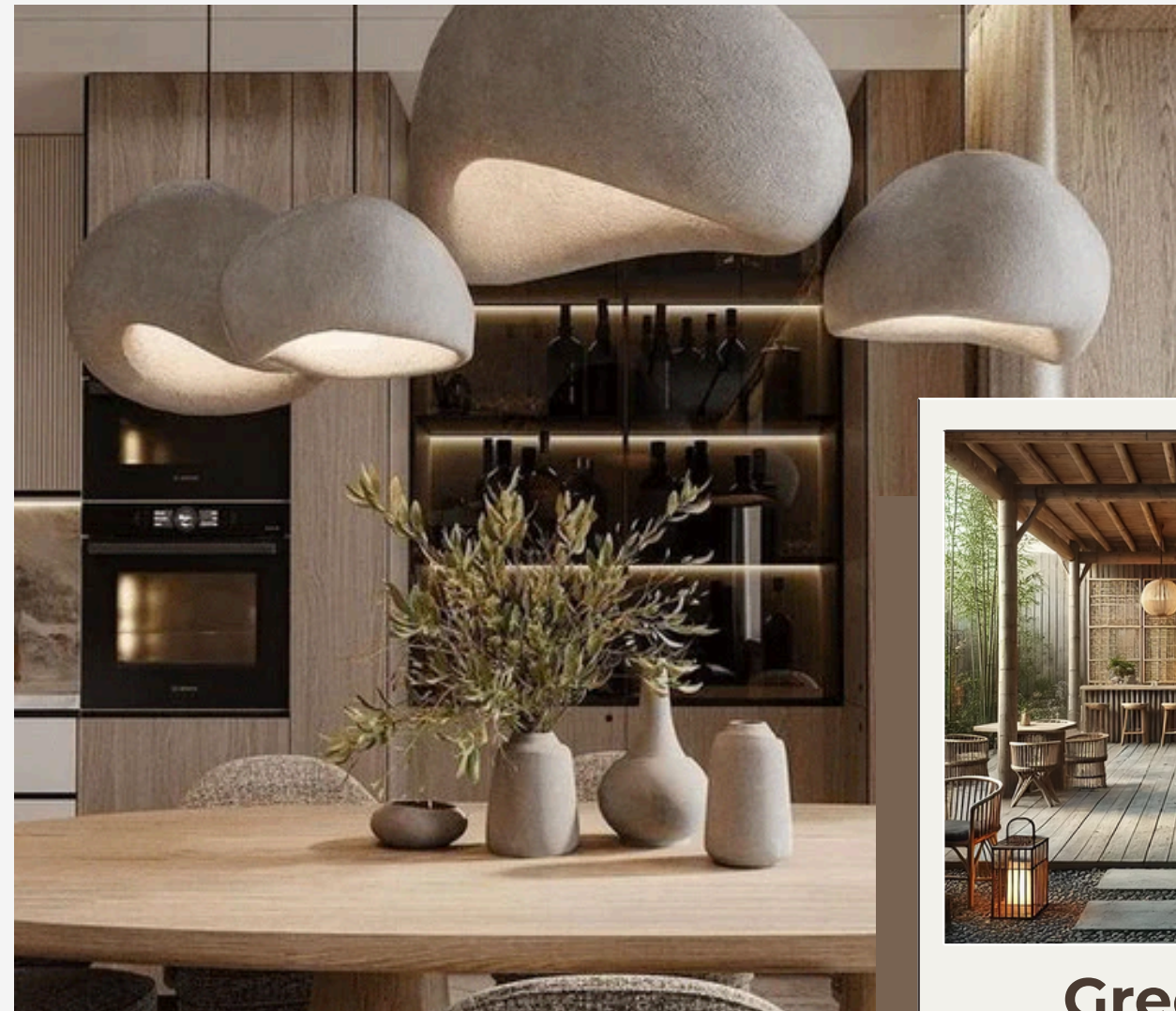

**Greenery**



**The Commoner’s Kitchen**

# AREA REQUIREMENT CHART

<i>CATEGORY/ SPACE</i>	<i>APPROX. AREA (SQ. FT.)</i>	<i>ACTUAL DIMENSIONS (FT)</i>	<i>NBC STANDARD SIZE (FT)</i>	<i>PURPOSE/ FUNCTION</i>
Indoor Seating & Circulation	500' – 600'	600'	10 – 15 sq.ft./person	Dining space with smooth circulation and seating arrangement
Kitchen	600'	33' x 10'11"	300' sq.ft. min. (NBC)	Cooking, food prep, plating,
Public Restroom	40' – 50'	8' x 8'4 1/2"	Min. 4' x 6'	Sanitary facility for customers
Staff Restroom	30' – 40'	8' x 8'4 1/2"	Min. 4' x 4'	Staff utility
Storage	40' – 60'	7' x 10'-11"	80' -100' sq.ft. (NBC)	Support area adjacent to kitchen
Outdoor / Semi-Open Seating	150' - 180'	13' x 15'5"	No fixed NBC limit	Open seating for dining and relaxation
Café Counter / Barista Zone	120'–150'	20' x 6'5"	120' sq.ft. min.	Beverage preparation, service, and customer interface
Reception	50' – 70'	11' x 5'-6"	6' – 10' clear width	Billing counter, initial customer interaction

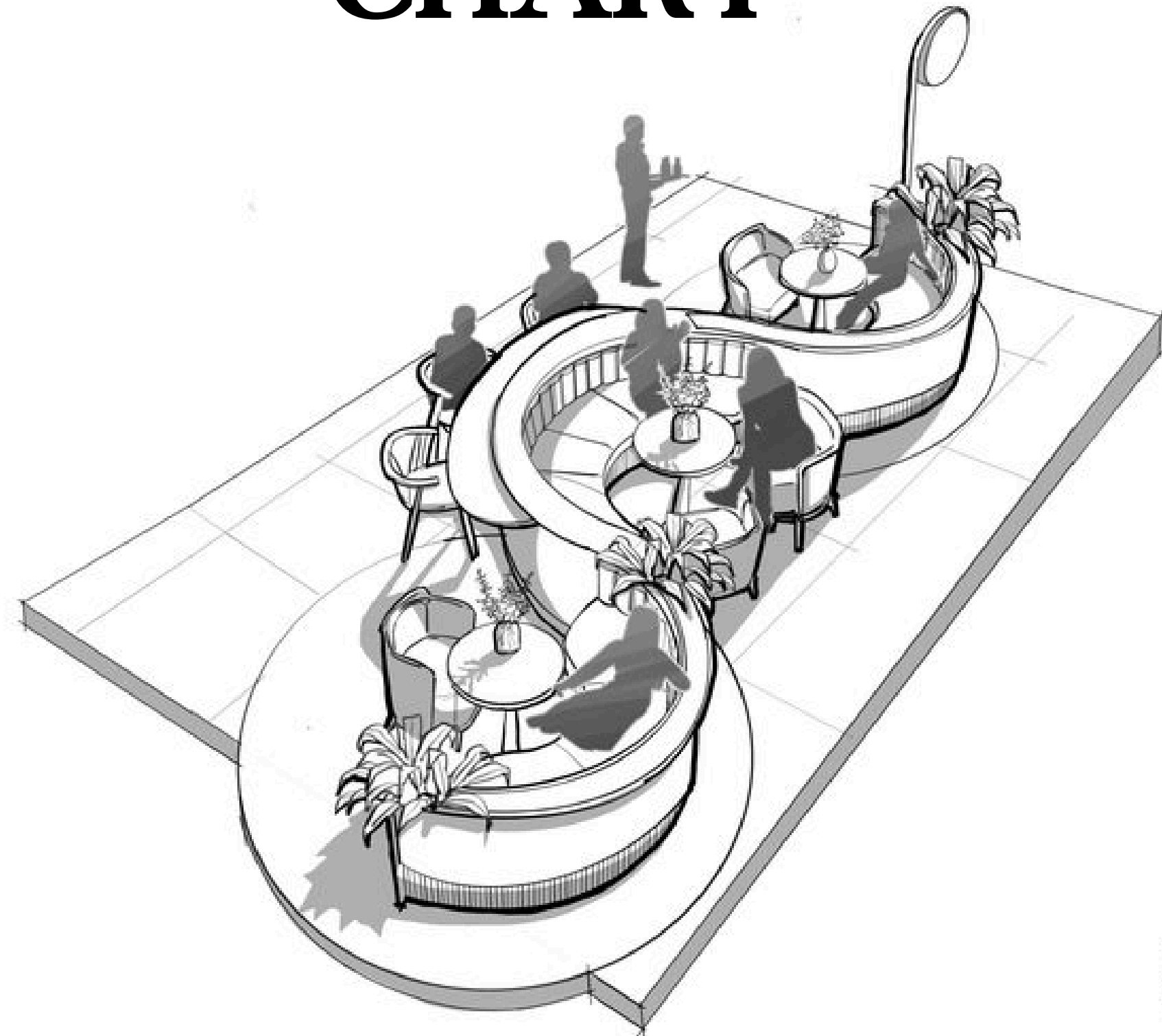

# ANTHROPOMETRIC STUDY



# INDOOR SEATING MODULE

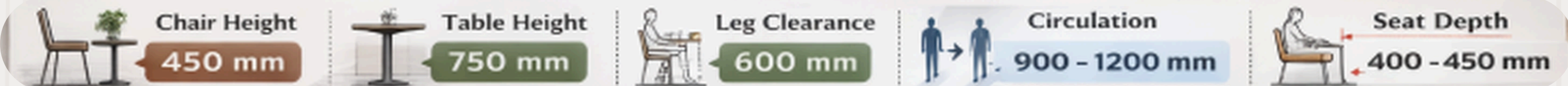
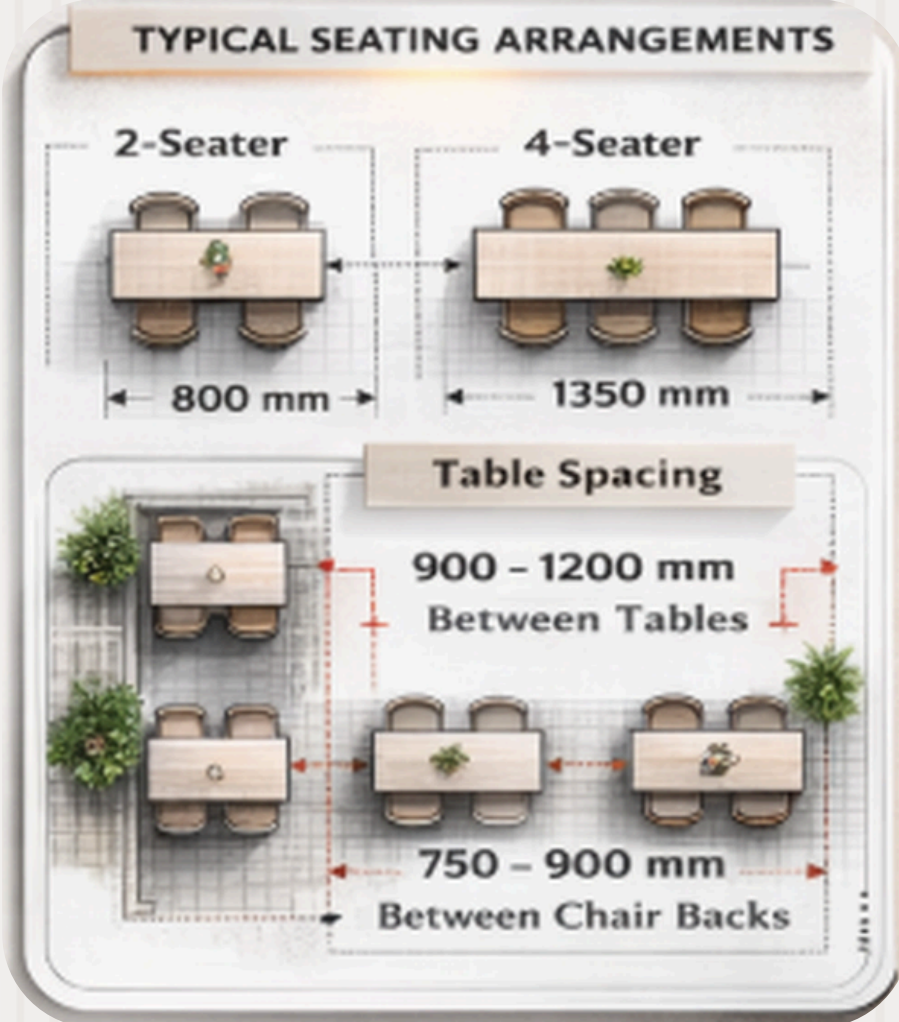
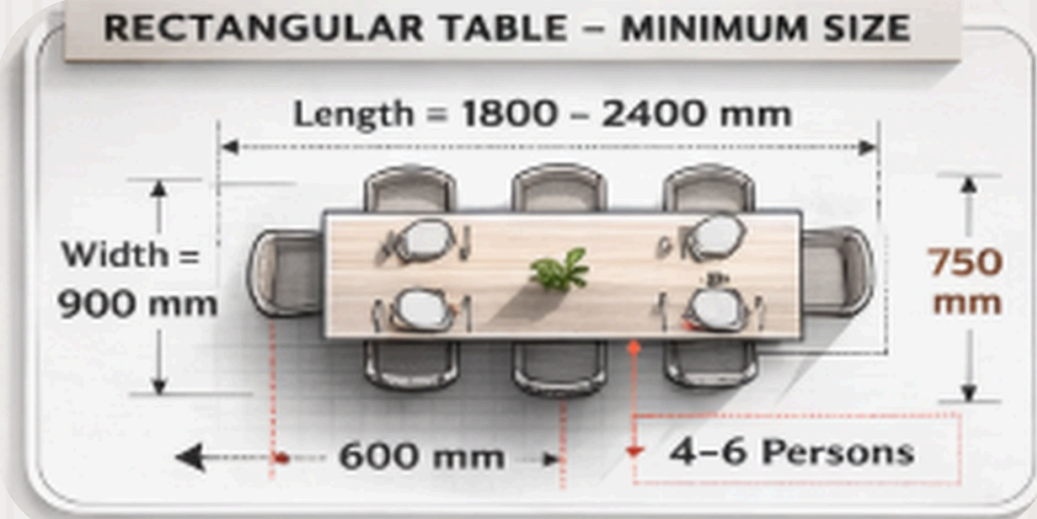
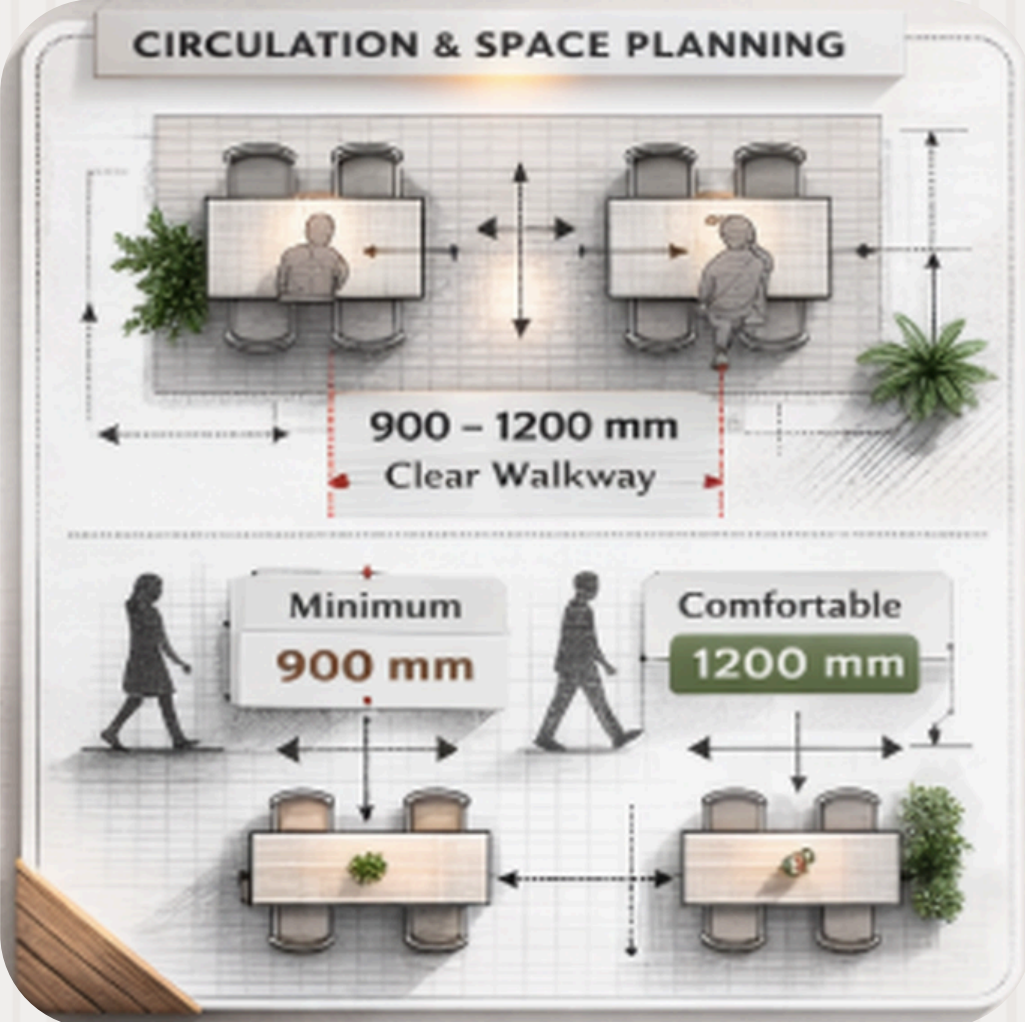
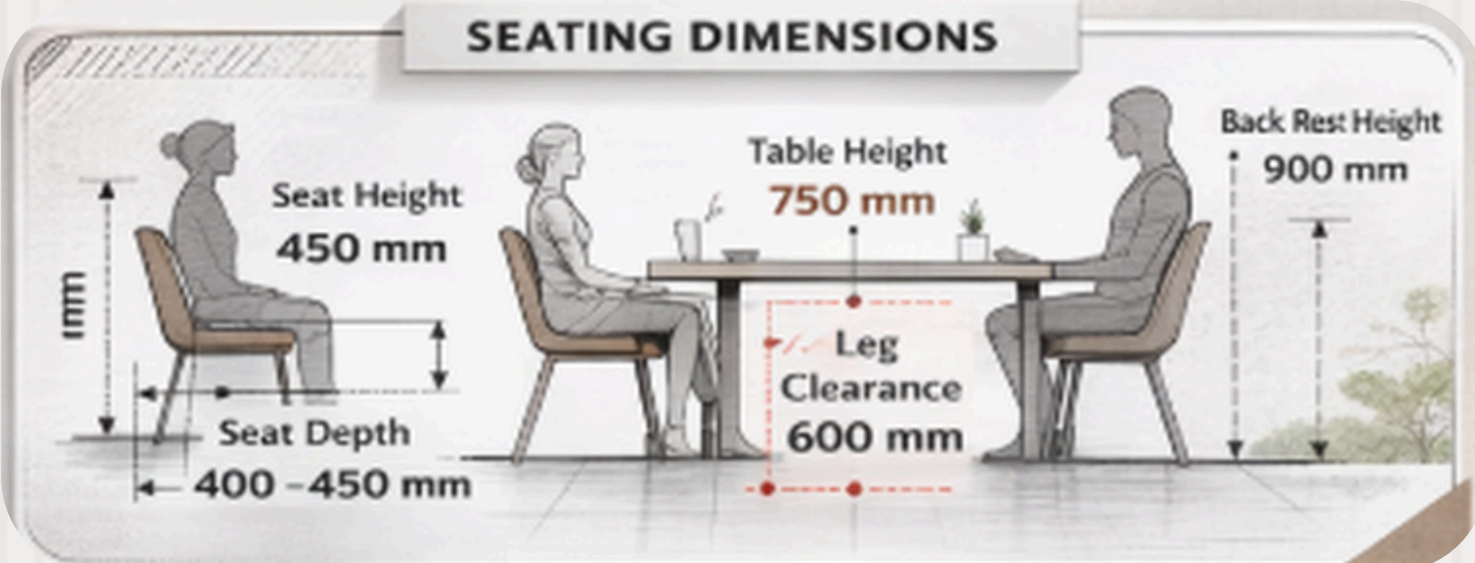
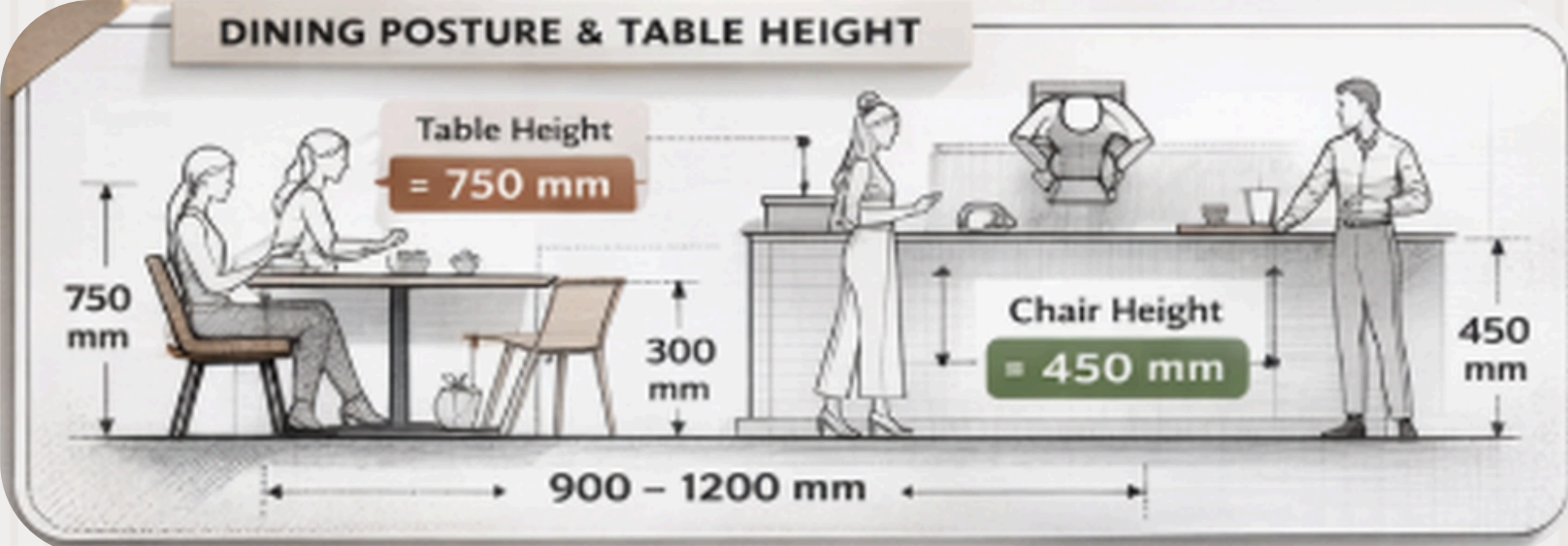

# KITCHEN MODULE

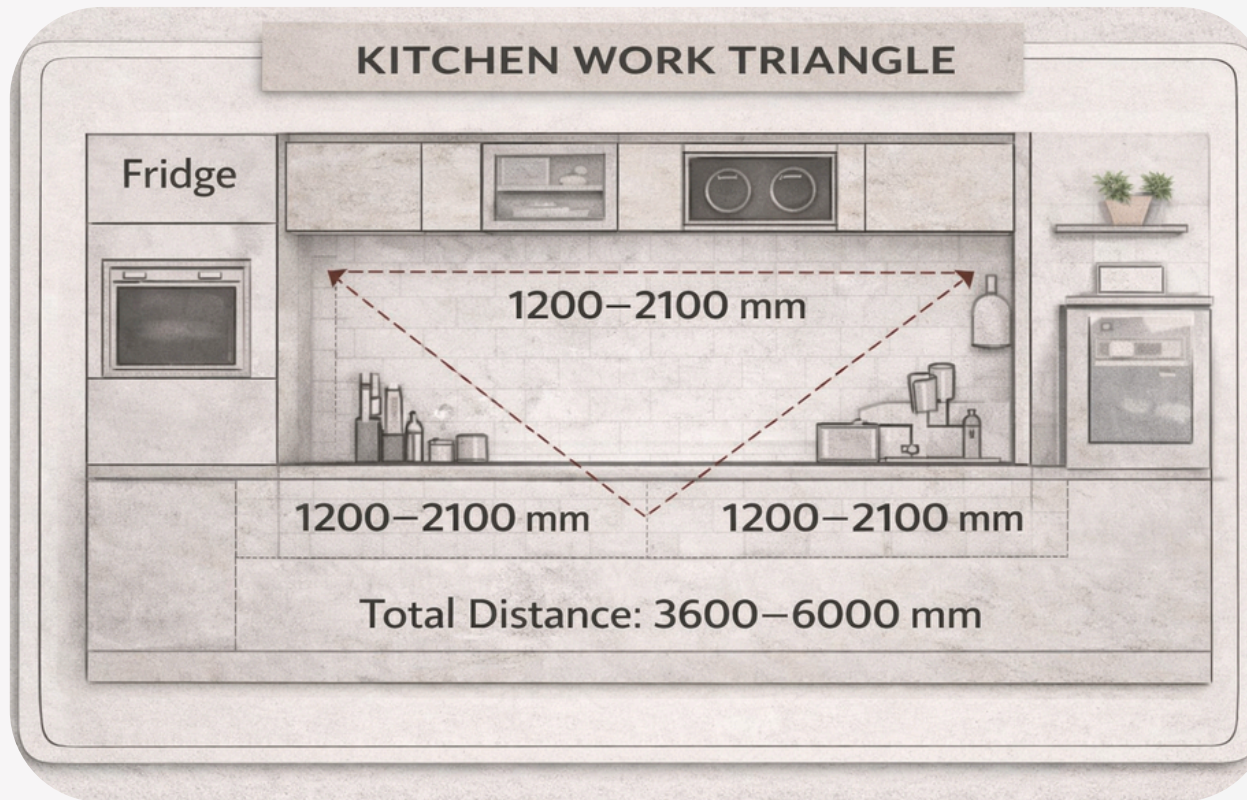
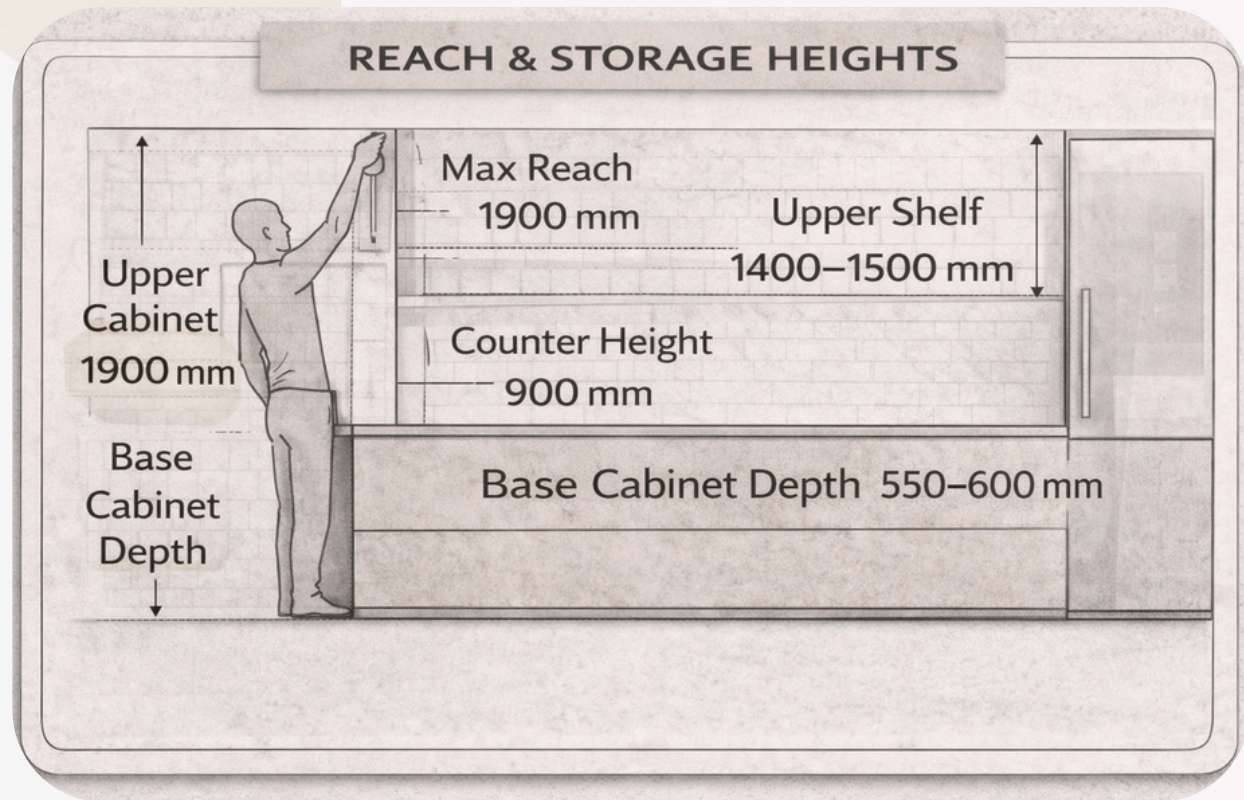
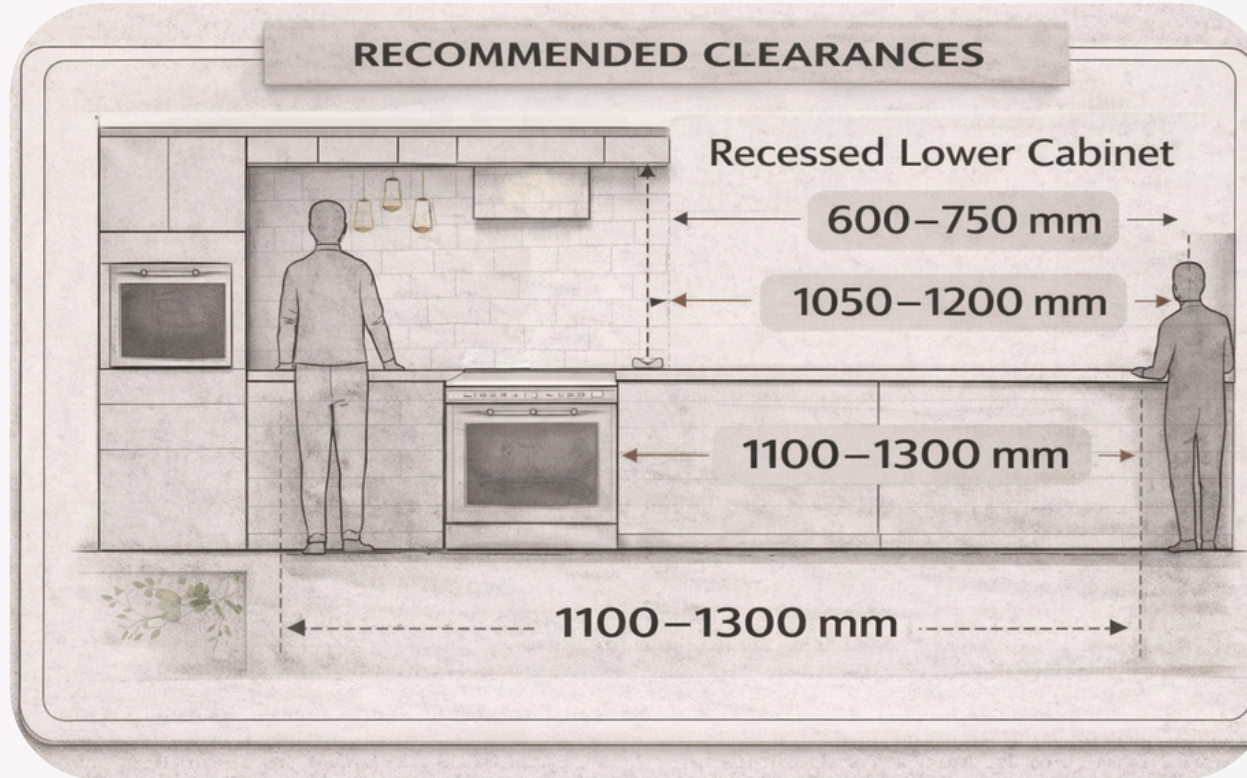
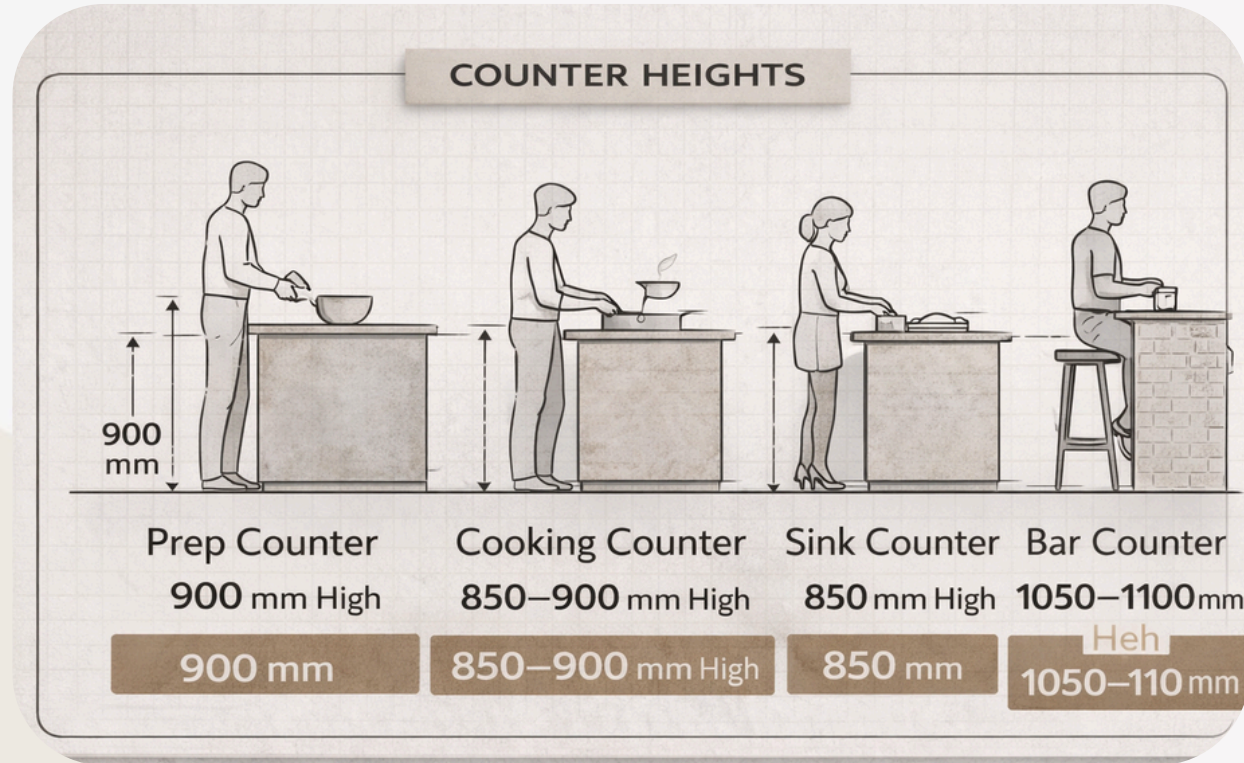

# Café Layouts



# SPATIAL PLANNING

(FURNITURE LAYOUT & FUNCTIONAL ZONING WITH DIMENSIONS)

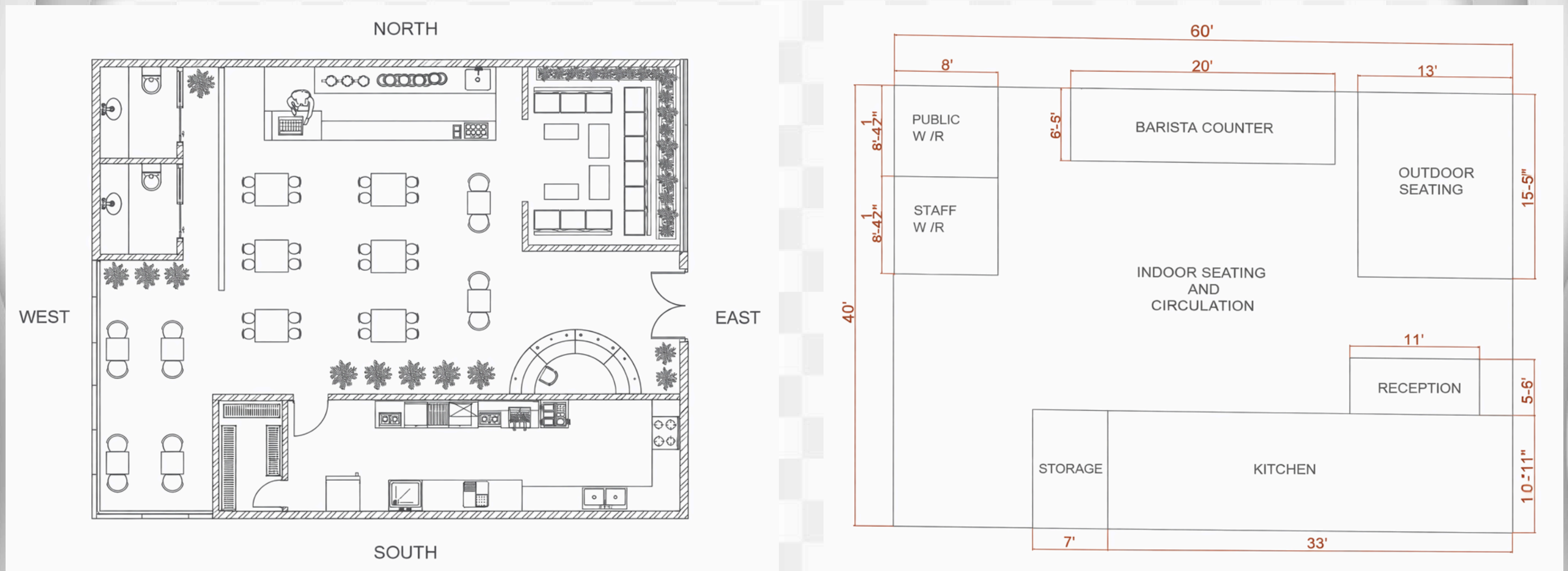

# PLUMBING & WATER SUPPLY LAYOUT

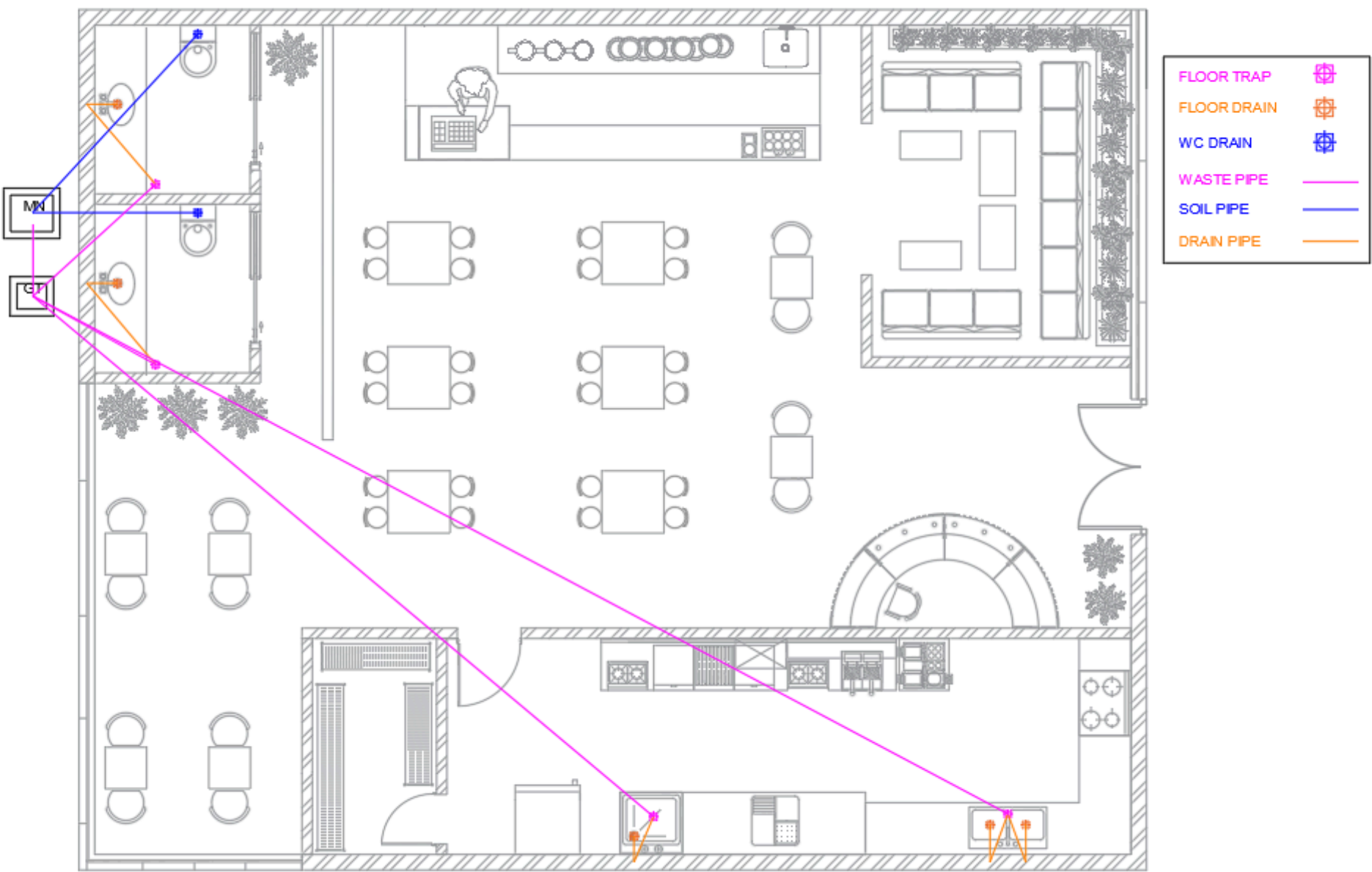

Drainage Layout

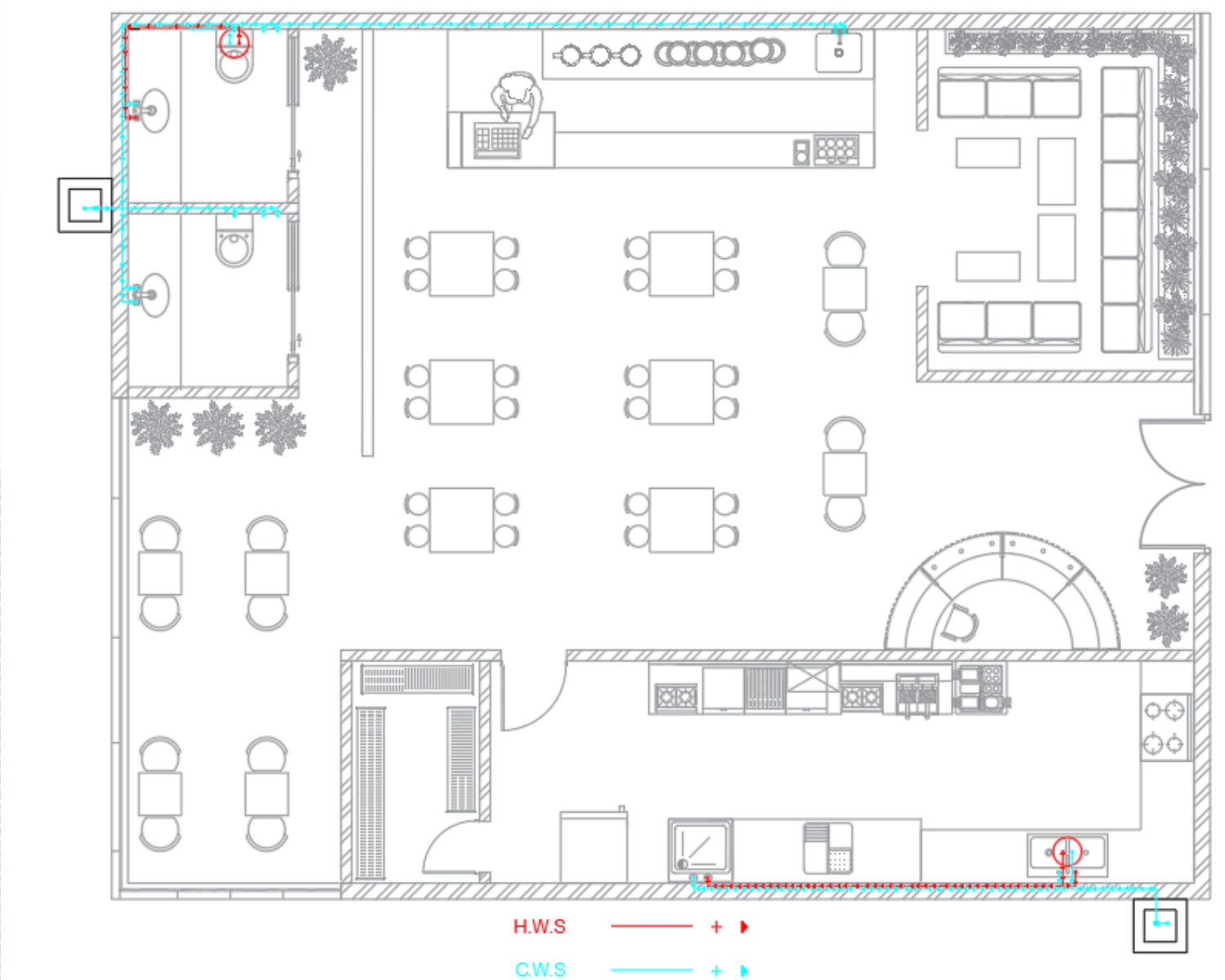

Water Supply Layout

# PLAN SHOWING SECTION LINES

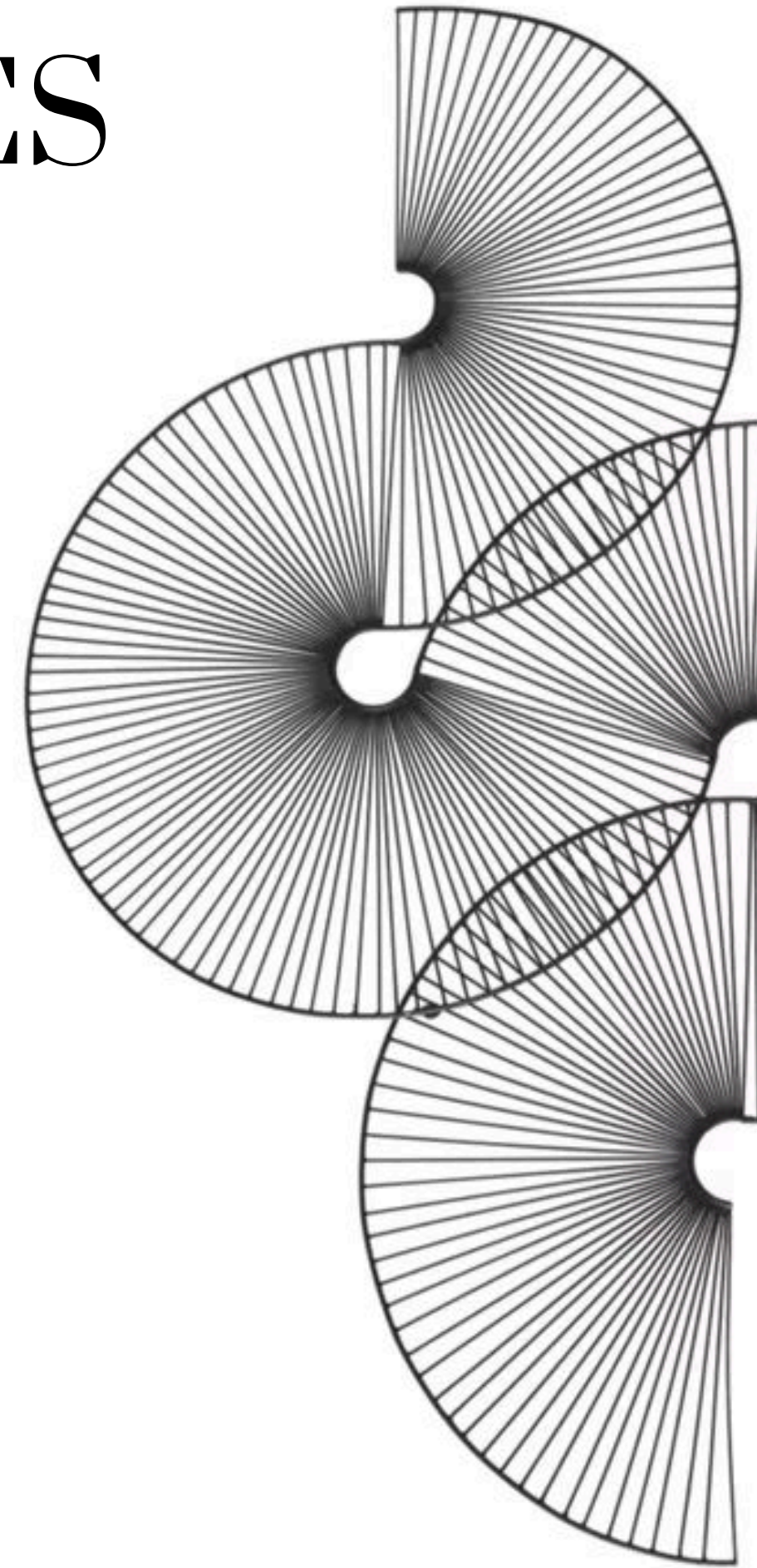
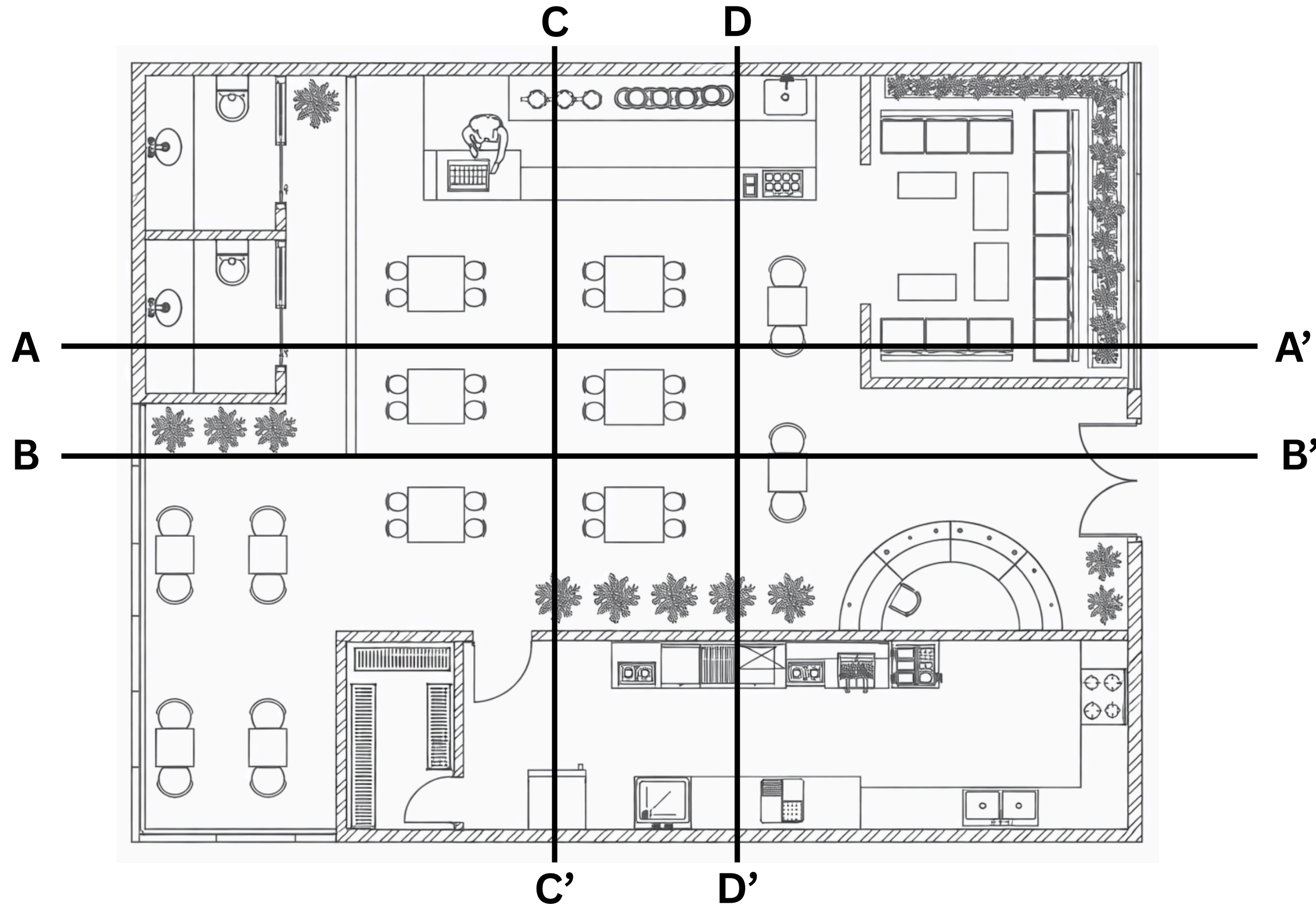



**SECTION A-A'**



**SECTION B-B'**



**SECTION C-C'**



**SECTION D-D'**

# 3D Visualizations

# *Isometric View*





# TOP VIEW

# ZEN LEAF CAFÉ

















Thankyou